

**CITY OF HIGHLAND VILLAGE  
NOTICE OF PUBLIC HEARINGS**

Notice is hereby given that the Planning & Zoning Commission and the Highland Village City Council will conduct public hearings at their regular meetings as follows in the City Hall Council Chambers, 1000 Highland Village Road, Highland Village, Texas:

Planning & Zoning Commission	August 20, 2019	7:00 p.m.
------------------------------	-----------------	-----------

Highland Village City Council	August 27, 2019	7:30 p.m.
-------------------------------	-----------------	-----------

The purpose of the hearings is to receive public comment on proposed amendment to the Planned Development on a total of approximate 23.471 ± acres tract of land located in the J. Edmonson Subdivision, Abstract A0398A, said property being located at the Northeast corner of Harlington Drive and Chinn Chapel Road, commonly known as 2601 Harlington Drive.

All persons interested are encouraged to attend this hearing. Persons wishing their opinion to be part of the record who are unable to attend may send a written reply prior to the date of the hearing(s) to the City of Highland Village c/o Autumn Aman, Community Development Coordinator, 1000 Highland Village Rd., Highland Village, Texas 75077 or e-mail [aaman@highlandvillage.org](mailto:aaman@highlandvillage.org).



**SITE DATA**

PROPOSED ZONING: PD-8, SF-8  
 MINIMUM LOT AREA: 8,400 SF  
 MINIMUM LOT WIDTH: 65'  
 MINIMUM LOT DEPTH: 100'  
 R.O.W. WIDTH: 50'

**BUILDING SETBACKS**

FRONT YARD: 25'  
 STREET SIDE YARD: 25'  
 INTERIOR SIDE YARD: 12' with 5' Min.  
 REAR YARD: 15'

PROPOSED LOT COUNT: 72 UNITS

65'x130' LOTS  
 UNIT COUNT: 35 UNITS  
 BUILDING AREA: 50'x90'

102.5'x130' LOTS (CORNER LOTS)  
 UNIT COUNT: 4 UNITS  
 BUILDING AREA: 70'x90'

82.5'x130' LOTS (CORNER LOTS)  
 UNIT COUNT: 2 UNITS  
 BUILDING AREA: 50'x90'

85.3'x130' LOTS (CORNER LOTS)  
 UNIT COUNT: 2 UNITS  
 BUILDING AREA: 52.8'x90'

70'x120' LOTS  
 UNIT COUNT: 7 UNITS  
 BUILDING AREA: 55'x80'

82.5'x120' LOTS (CORNER LOTS)  
 UNIT COUNT: 1 UNIT  
 BUILDING AREA: 50'x80'

75' X 123' LOTS  
 UNIT COUNT: 1 UNIT  
 BUILDING AREA: 60'x70'

68'x124' LOTS  
 UNIT COUNT: 12 UNITS  
 BUILDING AREA: 53' x 84'

79.4'x124' LOTS (CORNER LOTS)  
 UNIT COUNT: 8 UNITS  
 BUILDING AREA: 46.9'x84'

HARLINGTON DRIVE SINGLE-FAMILY  
 2601 HARLINGTON DRIVE  
 HIGHALND VILLAGE, TX

**CONCEPTUAL SITE PLAN**

SCALE: 1"=150' (11x17)

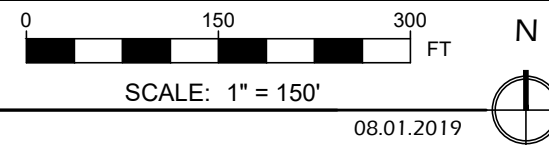

C.1



08.01.2019